

SERIES:

MGDH3



tyco Electronics

3003 9th Avenue SW
 PO Box 50
 Watertown, SD 57201
 Toll free: 888-978-2638
 Ph: 605-886-3326
 Fax: 605-886-8995



Low Profile, High Current Power Inductors

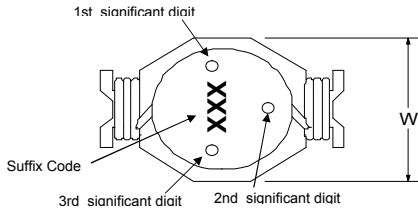
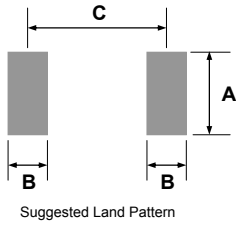

Parts will be marked with Significant Diat Dots OR Suffix code

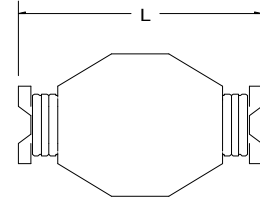
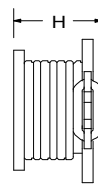

Series Number	Maximum Dimensions			Reference Dimensions			
	Units	L	W	H	A	B	C
MGDH3	inches	0.880"	0.640"	0.315"	0.340"	0.125"	0.690"
	[mm]	[22.35]	[16.26]	[8.00]	[8.64]	[3.18]	[17.53]

Features:

- High energy storage and low resistance
- Reliable surface mounting, flat top for pick and place.
- Smaller real estate than other common inductors.
- Robust temperature deflection to prevent damage during solder reflow.
- Tape and Reel mechanical specifications available upon request.
- Operating Temperature -40°C to +85°C.
- Highly resistive core for EMI suppression applications.
- Lead Free RoHS Compliant

Notes:

- Inductance measured at 100kHz and 100mVrms.
- Isat is a maximum applied AC + DC current.
- Isat current is applied to produce a typical 10% drop in nominal inductance.
- Tolerance suffix of M = ±20%.
- DCR is a maximum at 20°C.
- Irms current is applied to produce a typical 40°C temperature rise.



Terminal Plating is Hot-dipped SnAgCu
 260°C Maximum reflow temperature per J-STD020

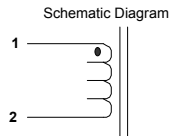

Lead-free Part Number	L μ H	MGDH3			
		DCR Ω	I _{SAT} A	I _{RMS}	Tolerance Suffix
MGDH3-00001	0.78	0.0026	30.0	15.0	M
MGDH3-00002	1.5	0.0040	25.0	15.0	M
MGDH3-00003	2.2	0.0061	20.0	12.0	M
MGDH3-00004	3.3	0.0086	17.0	10.0	M
MGDH3-00005	3.9	0.0100	15.0	9.0	M
MGDH3-00006	4.7	0.0140	13.0	8.4	M
MGDH3-00007	6.0	0.0170	12.0	7.5	M
MGDH3-00008	7.8	0.0180	11.0	7.5	M
MGDH3-00009	10	0.0260	10.0	6.0	M
MGDH3-00010	15	0.0320	8.0	4.4	M
MGDH3-00015	22	0.0450	7.6	4.5	M

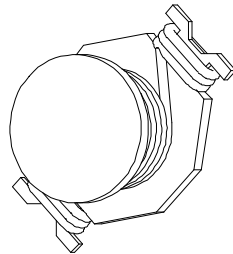
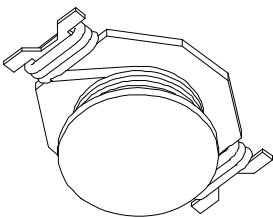

Contact CoEv for additional inductance values

Specifications subject to change

Call Toll Free: 888-978-2638 Website: www.tycopowercomponents.com